

## **Globe Valve, PN 16, PSI 200**

A Globe Valve with PN 16 and PSI 200 is designed for regulating flow in a pipeline. It typically features a spherical body shape and a movable disk element that controls fluid passage. These valves are commonly used in applications requiring precise flow control.

### **KEY FEATURES:**

- **Precise Flow Regulation:** Ideal for throttling applications due to the linear motion of the disk against the seat.
- **Robust Pressure Rating**
  - Dual pressure rating: PN 16 (European standard): 16 bar (200 PSI)
  - Suitable for moderate pressure systems in both metric and imperial setups.
- **Tight Shutoff Capability:** When fully closed, offers reliable sealing against the seat to prevent leakage.
- **Rising Stem Design:** Indicates valve position and allows easy visual inspection of whether it's open or closed.
- **Body Material Options:** Typically available in cast iron, ductile iron, carbon steel, or stainless steel to suit fluid compatibility and service requirements.
- **End Connections:** Threaded end according to EN 10226-1 and ISO 7-1.
- **Pressure-Temperature Compatibility:** Rated to handle full pressure at lower temperatures (e.g., 16 bar at 20°C) with derating required at higher temperatures.



## **APPLICATION:**

Here are the typical applications of a Globe Valve rated PN 16 / 200 PSI, focusing on where its flow control and moderate pressure capacity are best utilized:

- Industrial Applications:
- Water and Wastewater
- Oil & Gas / Petrochemical
- HVAC & Building Services
- Pharmaceutical and Food (Stainless Steel Models)
- Where hygienic control and cleanability are required, using SS 316 variants.

## **Why Globe Valves Are Preferred in These Applications:**

- Excellent throttling and flow control capability.
- Durable design for frequent operation.
- Reliable sealing performance.
- Compatible with various actuators for automation.

## **DRAWINGS AND DIMENSIONS:**

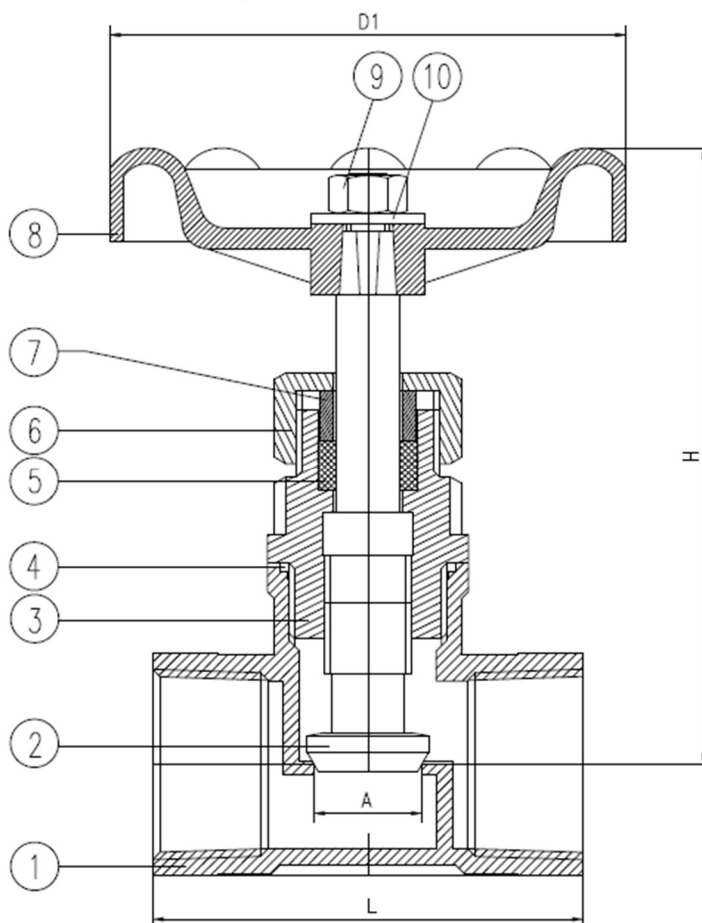



Unit: mm				
Size	L	H	A	D1
DN10 3/8"	45.00	80.00	10.00	68.00
DN15 1/2"	52.00	80.00	10.00	68.00
DN20 3/4"	60.00	86.00	15.00	68.00
DN25 1"	71.50	103.00	20.00	68.00
DN32 1 1/4"	81.00	105.00	25.00	98.00
DN40 1 1/2"	91.00	124.00	32.00	98.00
DN50 2"	101.00	138.00	40.00	98.00

**PART AND MATERIAL LIST:**

Sr. No.	Part Name	Material
1	BODY	ASTM-A351-CF8M
2	STEM	SS316
3	BONNET	ASTM-A351-CF8M
4	JOINT GASKET	PTFE
5	STEM PACKING	PTFE
6	PACKING NUT	ASTM-A351-CF8M
7	HIGH WASHER	SS304
8	HAND WHEEL	CAST ALUMINIUM
9	WHEEL NUT	SS304
10	NAME PLATE	ALUMINIUM

The information presented above is intended for general reference and product selection purposes. Specifications, features, and applications may vary depending on manufacturer and specific model.

Please consult the product manual or contact the supplier for detailed technical data and guidance tailored to your requirements. All images and descriptions are for illustrative purposes only and may not fully represent the actual product design.

Thank you!

---

**Swiss Fittings Argentina**

Telefon: +54 9 341 685 3540

E-Mail: [info@swiss-fittings.com.ar](mailto:info@swiss-fittings.com.ar) | Website: [www.swiss-fittings.com.ar](http://www.swiss-fittings.com.ar)